

PRE-FEASIBILITY STUDY SUMMARY

OVERVIEW

**Client:** Garment factory  
**Location:** District 9, HCMC  
**Type of building:** industry warehouse  
**Construction year:** 10 years  
**Operation pattern:** 6 days per week

ENERGY CONSUMPTION

**Annual Consumption:** *unknown*

**Main Usages:**

- Process lines
- Lighting system for production and offices
- Others

**Tariff Structure<sup>1</sup>:**

- Peak hours: 2,556 VND/kWh (11.5 US c/kWh)
- Normal hours: 1,405 VND/kWh (6.3 US c/kWh)
- Off-peak hours: 902 VND/kWh (4.0 US c/kWh)

SOLAR PV SYSTEM

**Size:** 254 kWp - 306 kWp  
**Energy yield:** 1,392 - 1,415 kWh/kWp.year  
**Annual production:** 354 - 433 MWh  
**Annual degradation:** 0.8%  
**Grid displacement:** *unknown*  
**Investment cost:** US\$ 393,700 - US\$ 474,300  
**Payback:** 10.5 years

**Description:**

- Two building-tied PV systems proposed, with no battery storage
- Full self-consumption on site
- The PV panels are mounted on the tilted roof (metal sheets)

For more information, please contact [solarhub@dragoncapital.com](mailto:solarhub@dragoncapital.com)

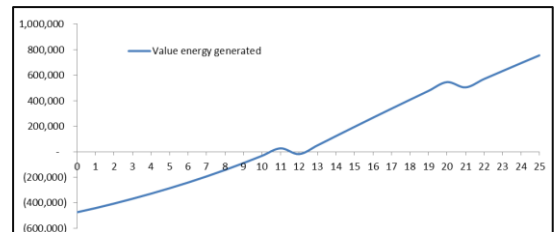
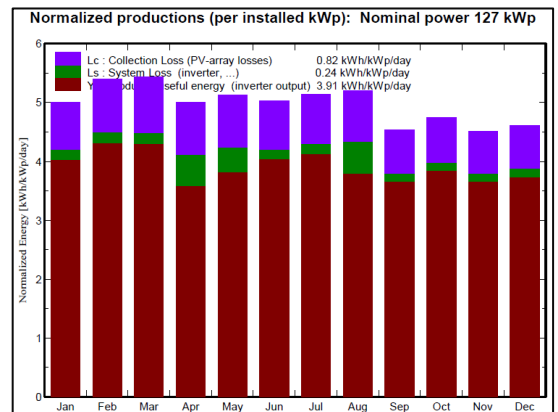
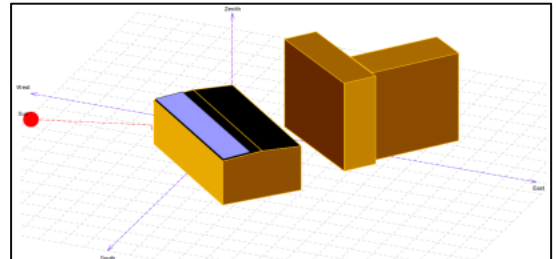

<sup>1</sup> Normal hours: Mon-Sat 04h00 - 09h30; 11h30 - 17h00; 20h00 - 22h00. Sun 04h00 - 22h00  
 Off-peak hours: Mon-Sun 22h00 - 04h00  
 Peak hours: Mon-Sat 09h30 - 11h30; 17h00 - 20h00